

Wall Mounting Kit

Assembly Instructions

Caution: do not discard parts or hardware.

Before starting assembly or discarding packaging, make sure all items listed in the parts are included.

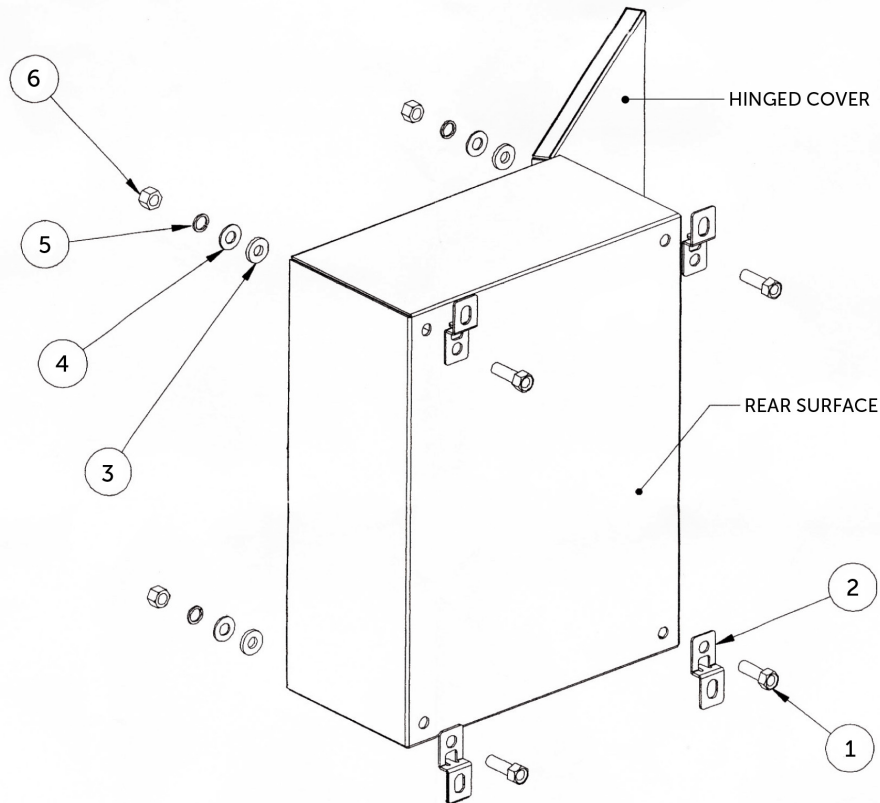

Parts List

Item Number	Description	Quantity
1	HEX BOLT - M10 x 20 mm	4
2	MOUNTING BRACKET	4
3	SEALING WASHER - 6 mm I.D. x 20 mm O.D.	4
4	FLAT WASHER - M10 x 20 mm	4
5	SPLIT LOCK WASHER - M10	4
6	HEX NUT - M10	4

NOTE:

1. Kit hardware must be assembled in the order shown to maintain watertight seal.
2. To maintain proper seal and UL rating, each HEX BOLT and HEX NUT must be torqued to 20 in -lbs.